

# MIXPAC System 50

Patents Granted & Pending

System Information 50-IA  
June 2002

## Dispenser - Manual

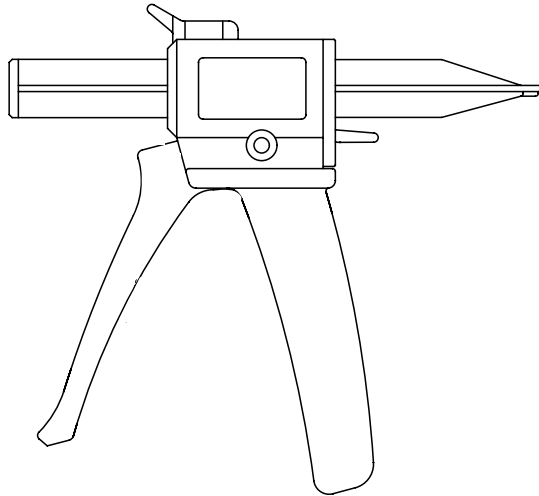

Dispenser, grey (includes Plunger 1:1) DMA 51-00-10

## Plungers - Various Ratios

1:1

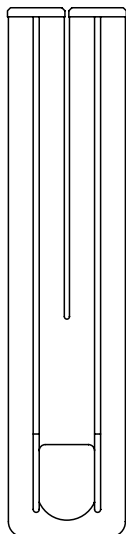

PLA 050-01

2:1

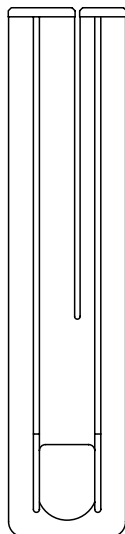

PLA 050-02

4:1

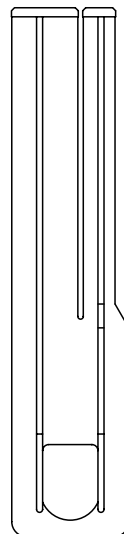

PLA 050-04

10:1

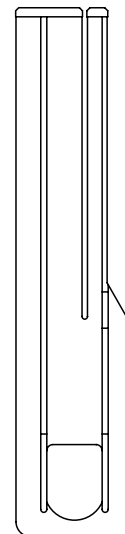

PLA 050-10

# Cartridge System 50

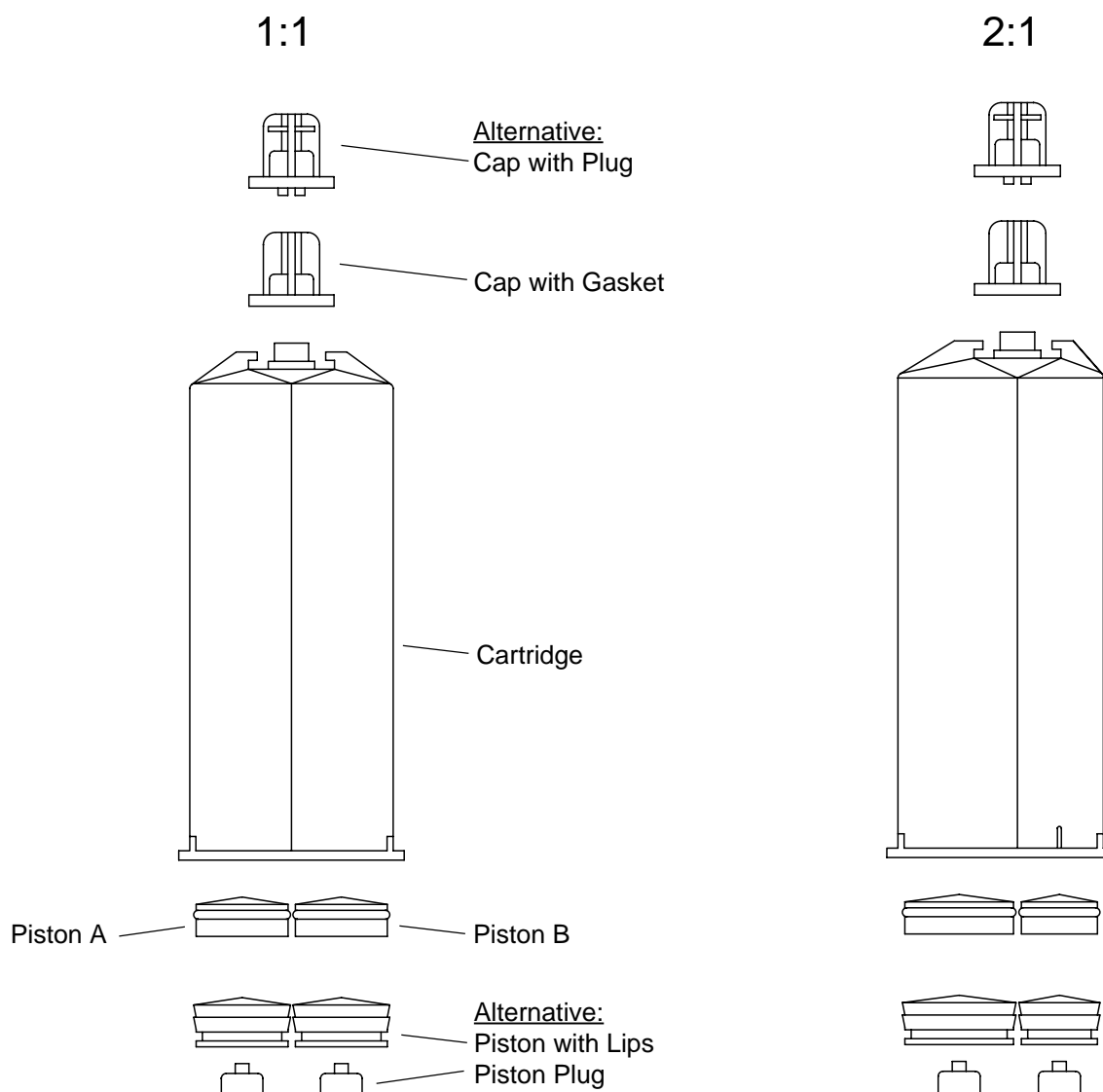

| Volumetric Ratio         | 1:1                          |                | 2:1          |              |
|--------------------------|------------------------------|----------------|--------------|--------------|
| Capacity (max.)          | 50 ml (75 ml also available) |                | 50 ml        |              |
| Material of Construction | PP                           | PA6 (Nylon)    | PP           | PA6 (Nylon)  |
| Cartridge                | CD 051-01-09                 | CD 051-01-19   | CD 051-02-09 | CD 051-02-18 |
| Piston A, EPDM O-Ring    | PD 051-01-EP                 | PD 055-01-EP   | PA 051-02-EP | PA 055-02-EP |
| Piston B, EPDM O-Ring    | (Piston A & B)               | (Piston A & B) | PB 051-02-EP | PB 055-02-EP |
| Cap with Gasket (PE)     | VA 050-00-G1                 | VA 050-00-G1   | VA 050-00-G1 | VA 050-00-G1 |
| Cap with Plug (Alcryn)   | VA 051-00-S1                 | VA 051-00-S1   | VA 051-00-S1 | VA 051-00-S1 |
| Cap with Plug (Silicone) | VA 051-00-S2                 | VA 051-00-S2   | VA 051-00-S2 | VA 051-00-S2 |
| Piston with Lips A       | PD 058-01-11                 | PD 059-01-28   | PA 058-02-11 | PA 059-02-28 |
| Piston with Lips B       | (Piston A & B)               | (Piston A & B) | PB 058-02-11 | PB 059-02-28 |
| Piston Plug              | PP 002-21                    | PP 002-21      | PP 002-21    | PP 002-21    |

4:1

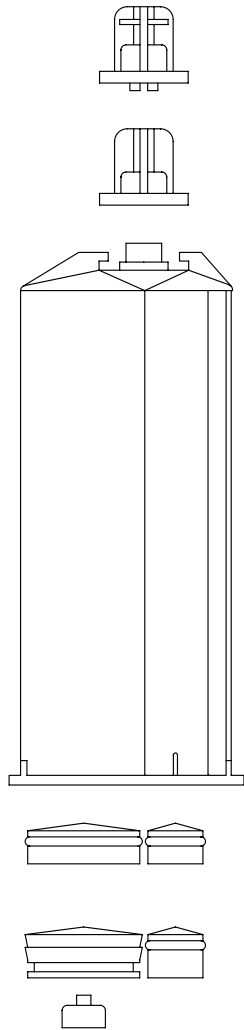

10:1

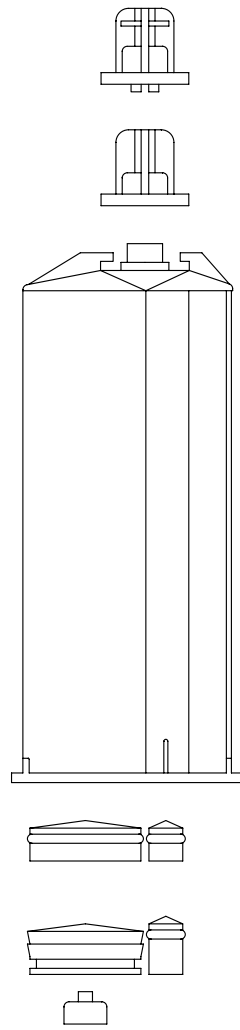

| Volumetric Ratio                | 4:1          |              | 10:1         |              |
|---------------------------------|--------------|--------------|--------------|--------------|
| Capacity (max.)                 | 42 ml        |              | 37 ml        |              |
| Material of Construction        | PP           | PA6 (Nylon)  | PP           | PA6 (Nylon)  |
| <b>Cartridge</b>                | CD 051-04-09 | CD 051-04-18 | CD 050-10-09 | CD 050-10-18 |
| <b>Piston A, EPDM O-Ring</b>    | PA 051-04-EP |              | PA 050-10-EP | PA 055-10-EP |
| <b>Piston B, EPDM O-Ring</b>    | PB 051-04-EP |              | PB 050-10-EP | PB 055-10-EP |
| <b>Cap with Gasket (PE)</b>     | VA 050-00-G1 | VA 050-00-G1 | VA 050-00-G1 | VA 050-00-G1 |
| <b>Cap with Plug (Alcryn)</b>   | VA 051-00-S1 | VA 051-00-S1 | VA 051-00-S1 | VA 051-00-S1 |
| <b>Cap with Plug (Silicone)</b> | VA 051-00-S2 | VA 051-00-S2 | VA 051-00-S2 | VA 051-00-S2 |
| <b>Piston A with Lips</b>       |              | PA 059-04-28 |              | PA 059-10-28 |
| <b>Piston B Long</b>            |              | PB 054-04-EP |              | PB 054-10-EP |
| <b>Piston Plug</b>              |              | PP 002-21    |              | PP 002-21    |

## Mixers

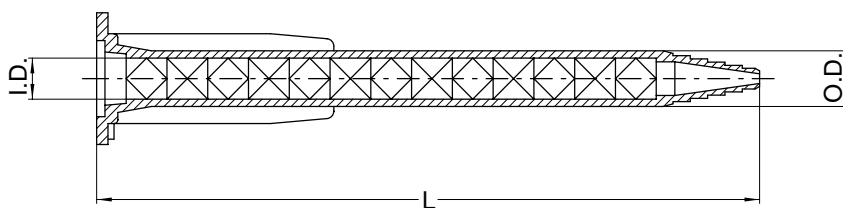

### MA - Style for Ratios 1:1 & 2:1

| Inner Dia.<br>I.D.<br>mm | Inner Dia.<br>I.D.<br>inch | Outer Dia.<br>O.D.<br>inch | Length<br>L<br>inch | Content<br>Volume<br>ml | Number<br>of<br>Elements | Part<br>Number |
|--------------------------|----------------------------|----------------------------|---------------------|-------------------------|--------------------------|----------------|
| 3.0                      | .118                       | .185                       | 1.31                | 0.19                    | 7                        | MA 3.0-07-S    |
| 3.0                      | .118                       | .185                       | 2.00                | 0.29                    | 13                       | MA 3.0-13-S    |
| 3.0                      | .118                       | .185                       | 2.46                | 0.34                    | 17                       | MA 3.0-17-S    |
| 4.0                      | .157                       | .228                       | 2.60                | 0.60                    | 13                       | MA 4.0-13-S    |
| 4.0                      | .157                       | .228                       | 3.21                | 0.75                    | 17                       | MA 4.0-17-S    |
| 5.4                      | .213                       | .276                       | 2.19                | 0.78                    | 7                        | MA 5.4-07-S    |
| 5.4                      | .213                       | .276                       | 3.33                | 1.36                    | 13                       | MA 5.4-13-S    |
| 5.4                      | .213                       | .299                       | 4.08                | 1.68                    | 17                       | MA 5.4-17-S    |
| 5.4                      | .213                       | .299                       | 4.88                | 2.01                    | 21                       | MA 5.4-21-S    |
| 6.3                      | .248                       | .339                       | 3.82                | 2.08                    | 12                       | MA 6.3-12-S    |
| 6.3                      | .248                       | .339                       | 5.04                | 2.92                    | 17                       | MA 6.3-17-S    |
| 6.3                      | .248                       | .339                       | 5.96                | 3.33                    | 21                       | MA 6.3-21-L    |
| 6.3                      | .248                       | .339                       | 6.02                | 3.57                    | 21                       | MA 6.3-21-S    |
| 6.8                      | .268                       | .343                       | 3.44                | 2.24                    | 12                       | MA 6.8-12-I    |
| 5.4-4.0                  | .213-.157                  | .224-.228                  | 5.87                | 2.10                    | 17+13                    | MA 0517-0413   |

### MX - Style for Ratios 4:1 & 10:1

|         |           |           |      |      |       |              |
|---------|-----------|-----------|------|------|-------|--------------|
| 3.0     | .118      | .188      | 2.46 | 0.35 | 17    | MX 3.0-17-S  |
| 4.0     | .157      | .228      | 3.23 | 0.75 | 17    | MX 4.0-17-S  |
| 5.4     | .213      | .339      | 4.08 | 1.53 | 17    | MX 5.4-17-S  |
| 5.4-4.0 | .213-.157 | .224-.228 | 5.87 | 2.10 | 17+13 | MX 0517-0413 |

S = Stepped End

L = Luer Slip End

I = Outlet Bore Dia. 5 mm

## Luer Lock Adapter

(for Mixers with Nom. Dia. 5.4 mm & 6.3 mm only)

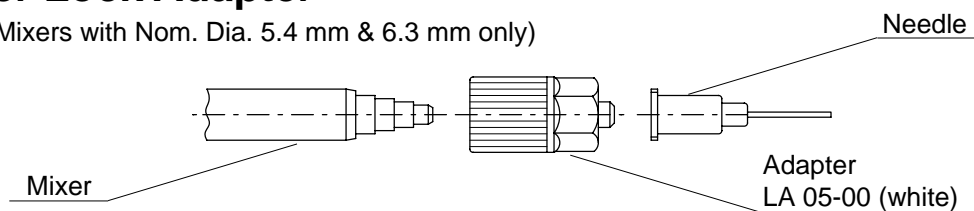

# MIXPAC System 200

Patents Granted & Pending

System Information 200-IA  
June 2002

## Dispensers - Pneumatic

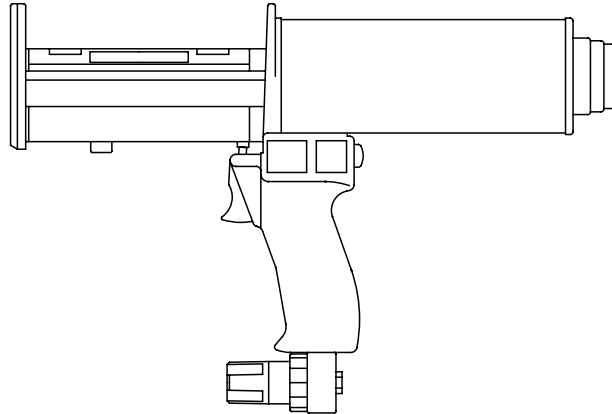

| Ratio     | Operating Pressure | Part Number  |
|-----------|--------------------|--------------|
| 1:1 & 2:1 | 73 psi             | DP 200-70-01 |
| 4:1       | 73 psi             | DP 200-70-04 |
| 10:1      | 73 psi             | DP 200-70-10 |

## Dispensers - Manual

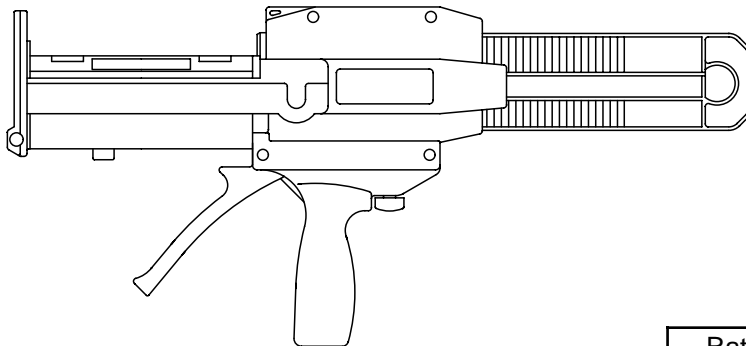

| Ratio     | Part Number |
|-----------|-------------|
| 1:1 & 2:1 | DM 200-01   |
| 4:1       | DM 200-04   |
| 10:1      | DM 200-10   |

# Cartridge System 200

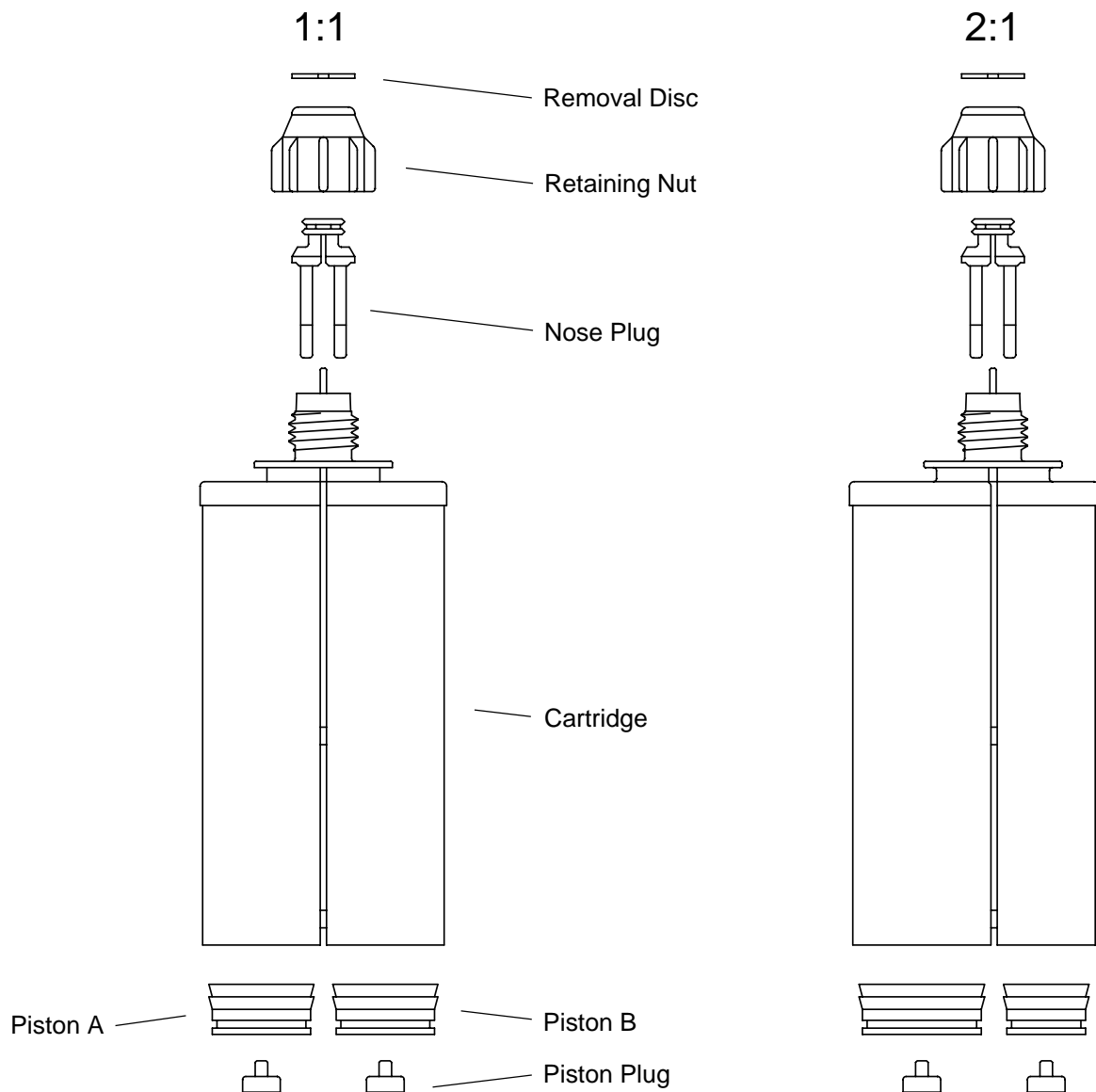

| Volumetric Ratio                        | 1:1            |                | 2:1          |  |
|---|----------------|----------------|--------------|--|
| Capacity (max.)                         | 210 ml         |                | 215 ml       |  |
| Material of Construction                | PP             | PA6 (Nylon)    | PP           |  |
| Cartridge                               | CD 200-01-14   | CD 201-01-18   | CD 200-02-14 |  |
| Piston A                                | PA 220-01-11   | PA 221-01-28   | PA 220-02-11 |  |
| Piston B                                | (Piston A & B) | (Piston A & B) | PB 220-02-11 |  |
| Piston Plug                             | PP 001-21      | PP 001-21      | PP 001-21    |  |
| Nose Plug                               | SL 002-01-23   | SL 002-01-24   | SL 002-01-23 |  |
| Retaining Nut (Nom. Dia. 3/16" to 3/8") | UM 10-PP       | UM 10-PP       | UM 10-PP     |  |
| Retaining Nut (Nom. Dia. 1/2" only)     | UM 13-PP       | UM 13-PP       | UM 13-PP     |  |
| Removal Disc                            | RD 001-00      | RD 001-00      | RD 001-00    |  |

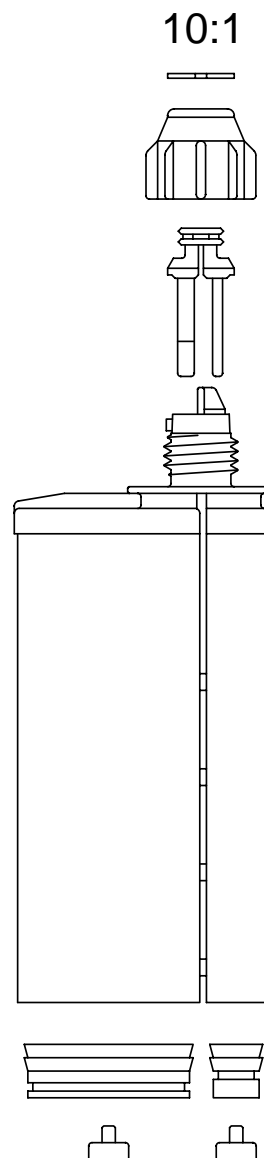
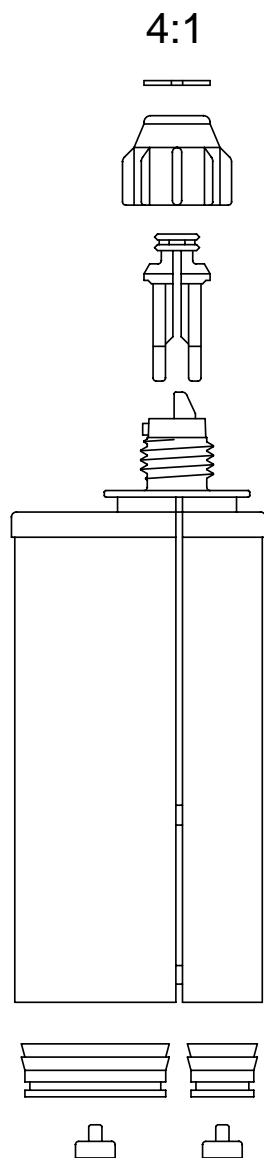

| Volumetric Ratio                        | 4:1          |  | 10:1         |              |
|---|--------------|--|--------------|--------------|
| Capacity (max.)                         | 225 ml       |  | 250 ml       |              |
| Material of Construction                | PP           |  | PP           | PBT *        |
| Cartridge                               | CD 200-04-14 |  | CD 200-10-A1 | CD 200-10-A2 |
| Piston A                                | PA 220-04-11 |  | PA 220-10-11 | PA 221-10-28 |
| Piston B                                | PB 220-04-11 |  | PB 220-10-11 | PB 221-10-28 |
| Piston Plug                             | PP 001-21    |  | PP 001-21    | PP 001-21    |
| Nose Plug                               | SL 002-04-23 |  | SL 202-10-23 | SL 202-10-24 |
| Retaining Nut (Nom. Dia. 3/16" to 3/8") | UM 10-PP     |  | UM 10-PP     | UM 10-PP     |
| Retaining Nut (Nom. Dia. 1/2" only)     | UM 13-PP     |  | UM 13-PP     | UM 13-PP     |
| Removal Disc                            | RD 001-00    |  | RD 001-00    | RD 001-00    |

\* Material: Polyester (PBT)

# Mixers

## MC - Style for Ratios 1:1 & 2:1

| Nominal I.D. inch | Inner Dia. I.D. inch | Outer Dia. O.D. inch | Length L inch | Approx. Content Vol. ml | Number of Elements | Part Number |
|-------------------|----------------------|----------------------|---------------|-------------------------|--------------------|-------------|
| 3/16              | .197                 | .315                 | 4.72          | 2.1                     | 18                 | MC 05-18    |
| 3/16              | .197                 | .315                 | 5.87          | 2.3                     | 24                 | MC 05-24    |
| 3/16              | .197                 | .315                 | 7.40          | 2.8                     | 32                 | MC 05-32    |
| 1/4               | .248                 | .394                 | 5.87          | 3.6                     | 18                 | MC 06-18    |
| 1/4               | .248                 | .394                 | 7.32          | 4.2                     | 24                 | MC 06-24    |
| 1/4               | .248                 | .394                 | 9.25          | 6.6                     | 32                 | MC 06-32    |
| 5/16              | .315                 | .472                 | 6.93          | 6.7                     | 18                 | MC 08-18    |
| 5/16              | .315                 | .472                 | 8.78          | 8.5                     | 24                 | MC 08-24    |
| 5/16              | .315                 | .472                 | 11.30         | 11.5                    | 32                 | MC 08-32    |
| 3/8               | .394                 | .551                 | 8.42          | 12.3                    | 18                 | MC 10-18    |
| 3/8               | .394                 | .551                 | 10.87         | 14.6                    | 24                 | MC 10-24    |
| 3/8               | .394                 | .551                 | 13.86         | 21.8                    | 32                 | MC 10-32    |
| 1/2               | .512                 | .669                 | 6.69          | 15.5                    | 12                 | MC 13-12    |
| 1/2               | .512                 | .669                 | 9.09          | 21.0                    | 18                 | MC 13-18    |
| 1/2               | .512                 | .669                 | 11.53         | 27.3                    | 24                 | MC 13-24    |
| 1/2               | .512                 | .669                 | 14.92         | 35.4                    | 32                 | MC 13-32    |

## MCX - Style for Ratios 4:1 & 10:1

|      |      |      |       |      |    |           |
|------|------|------|-------|------|----|-----------|
| 5/16 | .315 | .472 | 7.16  | 6.4  | 18 | MCX 08-18 |
| 5/16 | .315 | .472 | 9.05  | 9.3  | 24 | MCX 08-24 |
| 3/8  | .394 | .551 | 6.14  | 9.6  | 12 | MCX 10-12 |
| 3/8  | .394 | .551 | 8.46  | 11.9 | 18 | MCX 10-18 |
| 3/8  | .394 | .551 | 10.83 | 16.2 | 24 | MCX 10-24 |
| 1/2  | .512 | .669 | 7.56  | 11.6 | 12 | MCX 13-12 |

## Luer Lock Adapters

(for Mixers Nominal Dia. 3/16" to 3/8" only)

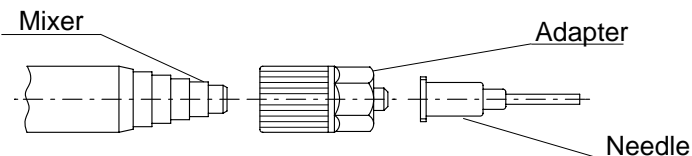

| Mixer Nom. Diameter | Part Number | Color |
|---------------------|-------------|-------|
| 3/16"               | LA 05-00    | white |
| 1/4" & 5/16"        | LA 06-08    | grey  |
| 3/8"                | LA 10-00    | black |



**MIXPAC<sup>®</sup>**

**System 400**

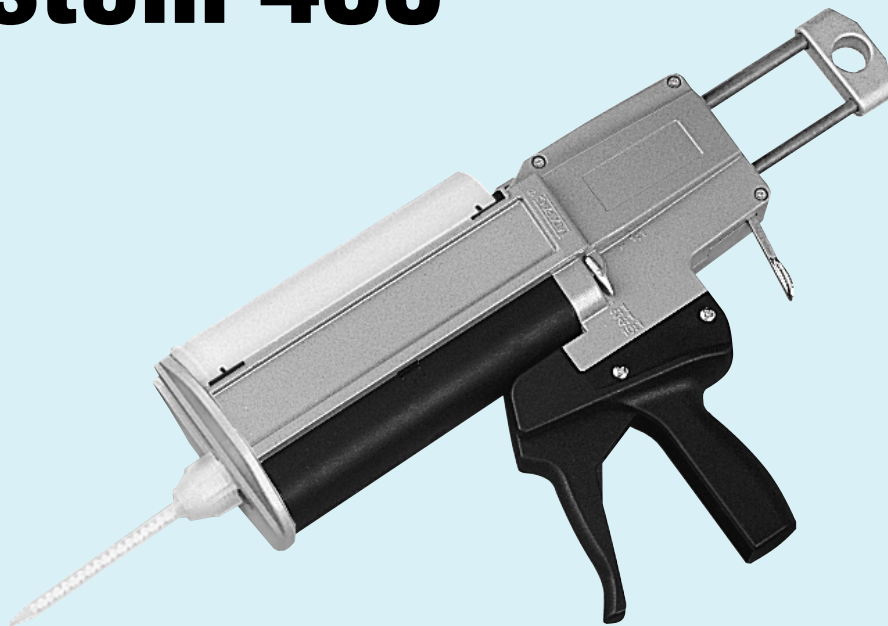

**Technical Data**

# MIXPAC System 400

Patents Granted & Pending

System Information 400-IA  
June 2002

## Dispensers - Pneumatic

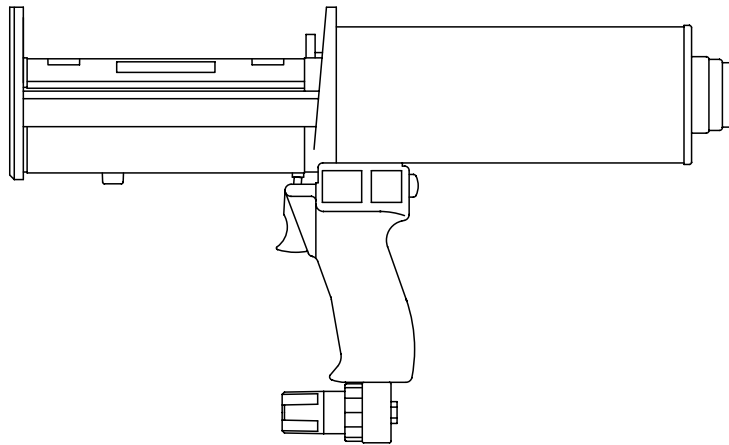

| Ratio     | Operating Pressure | Part Number  |
|-----------|--------------------|--------------|
| 1:1 & 2:1 | 73 psi             | DP 400-85-01 |
| 4:1       | 73 psi             | DP 400-85-04 |
| 10:1      | 73 psi             | DP 400-85-10 |

## Dispensers - Manual

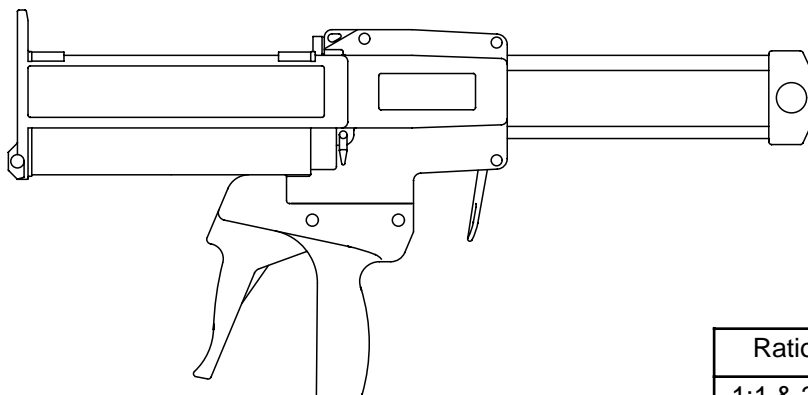

| Ratio     | Part Number |
|-----------|-------------|
| 1:1 & 2:1 | DM 400-01   |
| 4:1       | DM 400-04   |
| 10:1      | DM 400-10   |

# Cartridge System 400

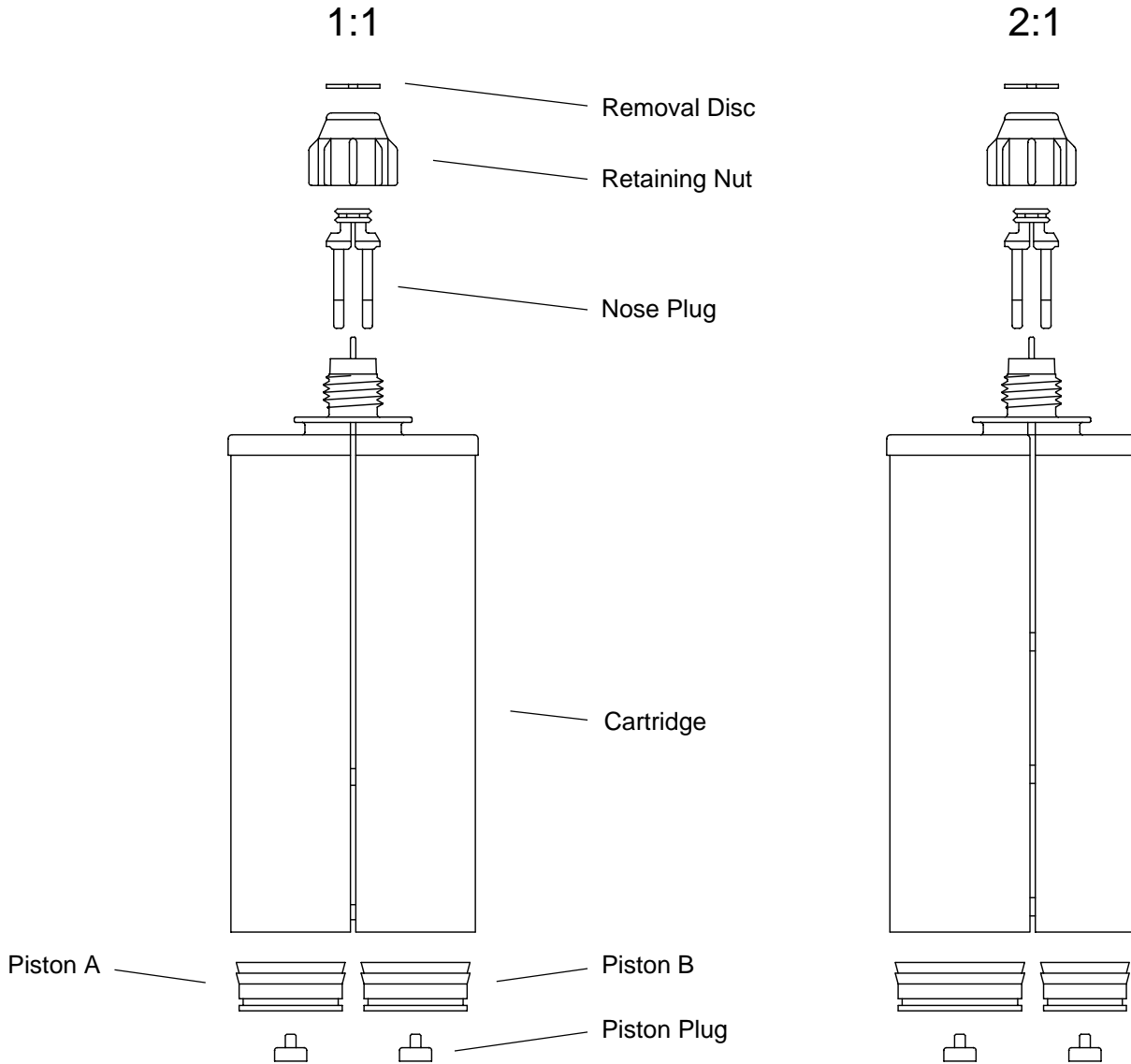

| Volumetric Ratio                        | 1:1            |                | 2:1          |  |
|---|----------------|----------------|--------------|--|
| Capacity (max.)                         | 395 ml         |                | 400 ml       |  |
| Material of Construction                | PP             | PA6 (Nylon)    | PP           |  |
| Cartridge                               | CD 400-01-14   | CD 401-01-18   | CD 400-02-14 |  |
| Piston A                                | PA 420-01-11   | PA 421-01-28   | PA 420-02-11 |  |
| Piston B                                | (Piston A & B) | (Piston A & B) | PB 420-02-11 |  |
| Piston Plug                             | PP 001-21      | PP 001-21      | PP 001-21    |  |
| Nose Plug                               | SL 002-01-23   | SL 002-01-24   | SL 002-01-23 |  |
| Retaining Nut (Nom. Dia. 3/16" to 3/8") | UM 10-PP       | UM 10-PP       | UM 10-PP     |  |
| Retaining Nut (Nom. Dia. 1/2" only)     | UM 13-PP       | UM 13-PP       | UM 13-PP     |  |
| Removal Disc                            | RD 001-00      | RD 001-00      | RD 001-00    |  |

\* 10:1 only: Cartridge and Nose Plug each consist of part A & B

\*\* Material: Polyester (PBT) / Nylon (PA6)

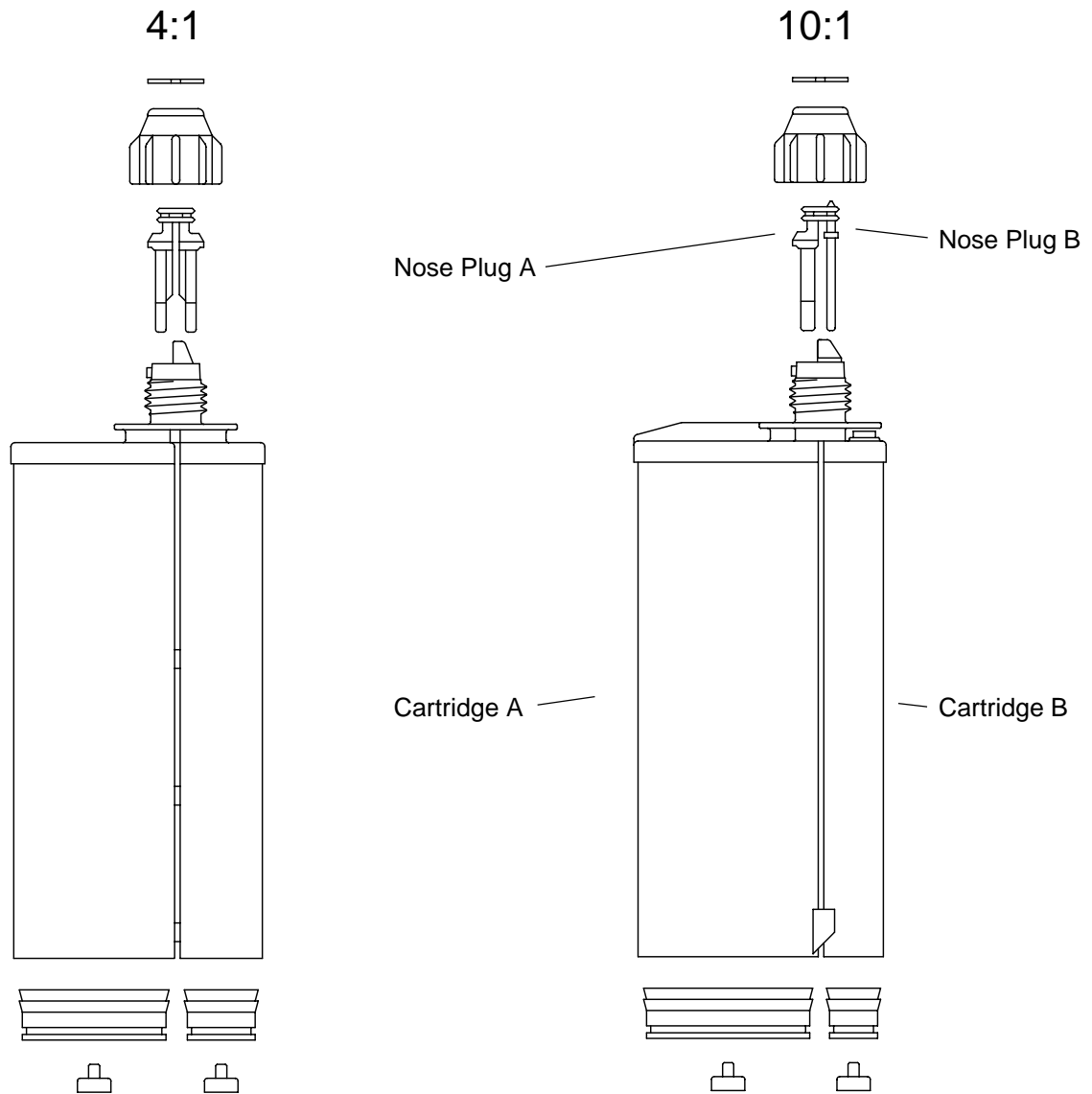

| Volumetric Ratio                        | 4:1          |  | 10:1 *       |              |
|---|--------------|--|--------------|--------------|
| Capacity (max.)                         | 415 ml       |  | 490 ml       |              |
| Material of Construction                | PP           |  | PP           | PBT/PA6 **   |
| Cartridge A *                           | CD 400-04-14 |  | CA 400-10-14 | CA 403-10-06 |
| Cartridge B *                           |              |  | CB 400-10-14 | CB 401-10-18 |
| Piston A                                | PA 420-04-11 |  | PA 420-10-11 | PA 421-10-28 |
| Piston B                                | PB 420-04-11 |  | PB 420-10-11 | PB 421-10-28 |
| Piston Plug                             | PP 001-21    |  | PP 001-21    | PP 001-21    |
| Nose Plug A *                           | SL 002-04-23 |  | SA 402-10-23 | SA 402-10-24 |
| Nose Plug B *                           |              |  | SB 402-10-23 | SB 402-10-24 |
| Retaining Nut (Nom. Dia. 3/16" to 3/8") | UM 10-PP     |  | UM 10-PP     | UM 10-PP     |
| Retaining Nut (Nom. Dia. 1/2" only)     | UM 13-PP     |  | UM 13-PP     | UM 13-PP     |
| Removal Disc                            | RD 001-00    |  | RD 001-00    | RD 001-00    |

# Mixers

## MC - Style for Ratios 1:1 & 2:1

| Nominal I.D. inch | Inner Dia. I.D. inch | Outer Dia. O.D. inch | Length L inch | Approx. Content Vol. ml | Number of Elements | Part Number |
|-------------------|----------------------|----------------------|---------------|-------------------------|--------------------|-------------|
| 3/16              | .197                 | .315                 | 4.72          | 2.1                     | 18                 | MC 05-18    |
| 3/16              | .197                 | .315                 | 5.87          | 2.3                     | 24                 | MC 05-24    |
| 3/16              | .197                 | .315                 | 7.40          | 2.8                     | 32                 | MC 05-32    |
| 1/4               | .248                 | .394                 | 5.87          | 3.6                     | 18                 | MC 06-18    |
| 1/4               | .248                 | .394                 | 7.32          | 4.2                     | 24                 | MC 06-24    |
| 1/4               | .248                 | .394                 | 9.25          | 6.6                     | 32                 | MC 06-32    |
| 5/16              | .315                 | .472                 | 6.93          | 6.7                     | 18                 | MC 08-18    |
| 5/16              | .315                 | .472                 | 8.78          | 8.5                     | 24                 | MC 08-24    |
| 5/16              | .315                 | .472                 | 11.30         | 11.5                    | 32                 | MC 08-32    |
| 3/8               | .394                 | .551                 | 8.42          | 12.3                    | 18                 | MC 10-18    |
| 3/8               | .394                 | .551                 | 10.87         | 14.6                    | 24                 | MC 10-24    |
| 3/8               | .394                 | .551                 | 13.86         | 21.8                    | 32                 | MC 10-32    |
| 1/2               | .512                 | .669                 | 6.69          | 15.5                    | 12                 | MC 13-12    |
| 1/2               | .512                 | .669                 | 9.09          | 21.0                    | 18                 | MC 13-18    |
| 1/2               | .512                 | .669                 | 11.53         | 27.3                    | 24                 | MC 13-24    |
| 1/2               | .512                 | .669                 | 14.92         | 35.4                    | 32                 | MC 13-32    |

## MCX - Style for Ratios 4:1 & 10:1

|      |      |      |       |      |    |           |
|------|------|------|-------|------|----|-----------|
| 5/16 | .315 | .472 | 7.16  | 6.4  | 18 | MCX 08-18 |
| 5/16 | .315 | .472 | 9.05  | 9.3  | 24 | MCX 08-24 |
| 3/8  | .394 | .551 | 6.14  | 9.6  | 12 | MCX 10-12 |
| 3/8  | .394 | .551 | 8.46  | 11.9 | 18 | MCX 10-18 |
| 3/8  | .394 | .551 | 10.83 | 16.2 | 24 | MCX 10-24 |
| 1/2  | .512 | .669 | 7.56  | 11.6 | 12 | MCX 13-12 |

## Luer Lock Adapters

(for Mixers Nominal Dia. 3/16" to 3/8" only)

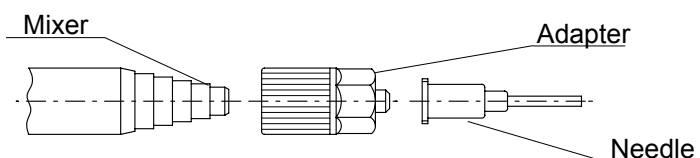

| Mixer Nom. Diameter | Part Number | Color |
|---------------------|-------------|-------|
| 3/16"               | LA 05-00    | white |
| 1/4" & 5/16"        | LA 06-08    | grey  |
| 3/8"                | LA 10-00    | black |



臺灣國瀚企業股份有限公司  
 GO-ON TECH ENTERPRISES CO., LTD  
 臺北縣三重市光復路2段80號7樓之3  
 7F-3 NO. 80 SEC. 2 KWANG FU RD.  
 SAN CHUNG CITY TAIPEI TAIWAN  
 E-mail: goon@goontech.com.tw  
 TEL: 886-2-29996191  
 FAX: 886-2-29996200

上海承瀚自動化設備有限公司  
 SHANGHAI GO-ON TECH CO., LTD  
 上海閘行區新鎮路1543號  
 NO. 1543 XINZHEN ROAD SHANGHAI CHINA  
 E-mail: goon@go-ontech.net  
 TEL: 86-21-64619771 64619772  
 FAX: 86-21-64619770